



JEEP 2018-23 JL NERF STEP

Thank you for choosing Rough Country for all your vehicle needs.

Please read instructions before beginning installation. Check the kit hardware against the kit contents shown below. Be sure you have all needed parts and know where they go.

If question exist, please call us @1-800-222-7023. We will be happy to answer any questions concerning this product.

Check all fasteners for proper torque. Check to ensure for adequate clearance between all components.

Periodically check all hardware for tightness.

KIT CONTENTS:

- Driver Side Nerf Step x1**
- Pass Side Nerf Step x1**
- Brackets x6**

TOOLS NEEDED:

- 13mm Wrench x2**
- 13mm Socket**

HARDWARE INCLUDED:

- 6 - 8mm x 35mm Bolt**
- 12 - 8mm x 25mm Bolt**
- 12 - 8mm x 20mm Bolt**
- 6 - 8mm Oversized Washer**
- 24 -8mm Flat Washer**
- 24 - 8mm Serrated Flange Nut**
- 6 - 5/16" Lock Washer**

Torque Specs:

Size	Grade 5	Grade 8	Size	Class 8.8	Class 10.9
5/16"	15 ft/lbs	20ft/lbs	6MM	5ft/lbs	9ft/lbs
3/8"	30 ft/lbs	35ft/lbs	8MM	18ft/lbs	23ft/lbs
7/16"	45 ft/lbs	60ft/lbs	10MM	32ft/lbs	45ft/lbs
1/2"	65 ft/lbs	90ft/lbs	12MM	55ft/lbs	75ft/lbs
9/16"	95 ft/lbs	130ft/lbs	14MM	85ft/lbs	120ft/lbs
5/8"	135ft/lbs	175ft/lbs	16MM	130ft/lbs	165ft/lbs
3/4"	185ft/lbs	280ft/lbs	18MM	170ft/lbs	240ft/lbs



INSTALLATION INSTRUCTIONS

1. Attach each of the brackets to the nerf step using the supplied 8mm x 20mm bolt, 8mm flat washer, and 8mm serrated flange nut. Tighten with two 13mm wrenches. **See Photo 1.**
2. Locate the factory mounting locations. **See Photo 2.**

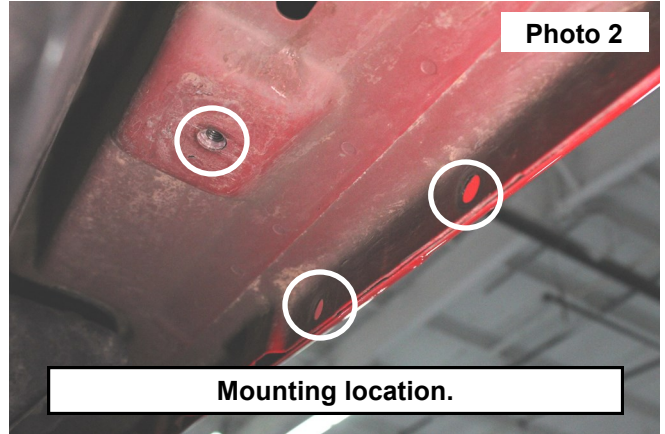
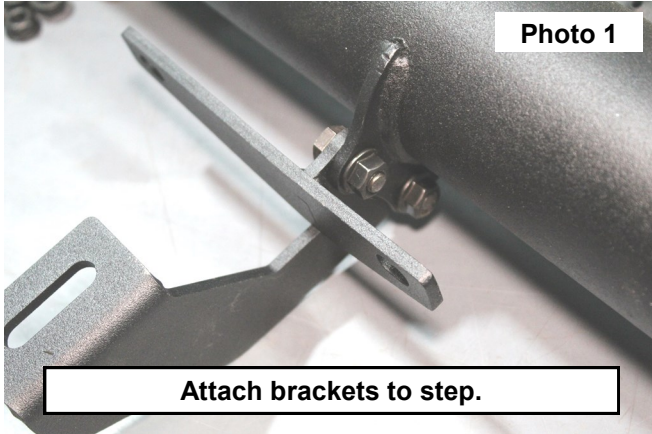

3. Use the supplied 8mm x 35mm, 8mm oversized washer, and 5/16" lock washer to secure the bracket to the vehicle body. Tighten with a 13mm socket. Do not fully tighten. **See Photo 3.**
4. Use supplied 8mm x 25mm bolts, 8mm flat washers, and 8mm serrated flange nuts to secure the bracket to the pinch weld. Tighten with two 13mm wrenches. **See Photo 4.**
5. Adjust step for desired fitment and tighten all hardware.
6. Repeat for other side.

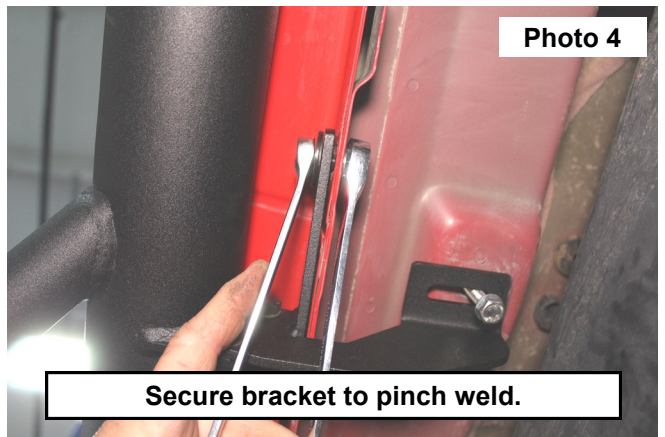
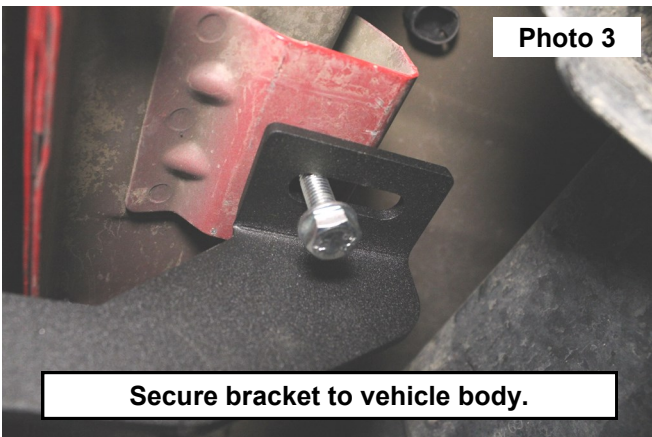

POST INSTALLATION INSTRUCTIONS

1. Check all fasteners for proper torque. Check to ensure for adequate clearance between all rotating, mobile, fixed, and heated members. Verify clearance between exhaust and brake lines, fuel lines, fuel tank, floorboards, and wiring harness.

By purchasing any item sold by Rough Country, LLC, the buyer expressly warrants that he/she is in compliance with all applicable, State, and Local laws and regulations regarding the purchase, ownership, and use of the item. It shall be the buyers responsibility to comply with all Federal, State and Local laws governing the sales of any items listed, illustrated or sold. The buyer expressly agrees to indemnify and hold harmless Rough Country, LLC for all claims resulting directly or indirectly from the purchase, ownership, or use of the items.

